

- ASSEMBLY NOTES:
- UNLESS DRAWINGS ARE MARKED "FOR CONSTRUCTION", THEY SHALL NOT BE USED FOR CONSTRUCTION PURPOSES
 - DO NOT OBTAIN DIMENSIONS BY SCALING FROM DRAWING
 - REMOVE ALL BURRS AND SHARP EDGES
 - ALL CUTS TO BE A MINIMUM OF CLASS 2 $\sqrt{3.2}$ FINISH UNO

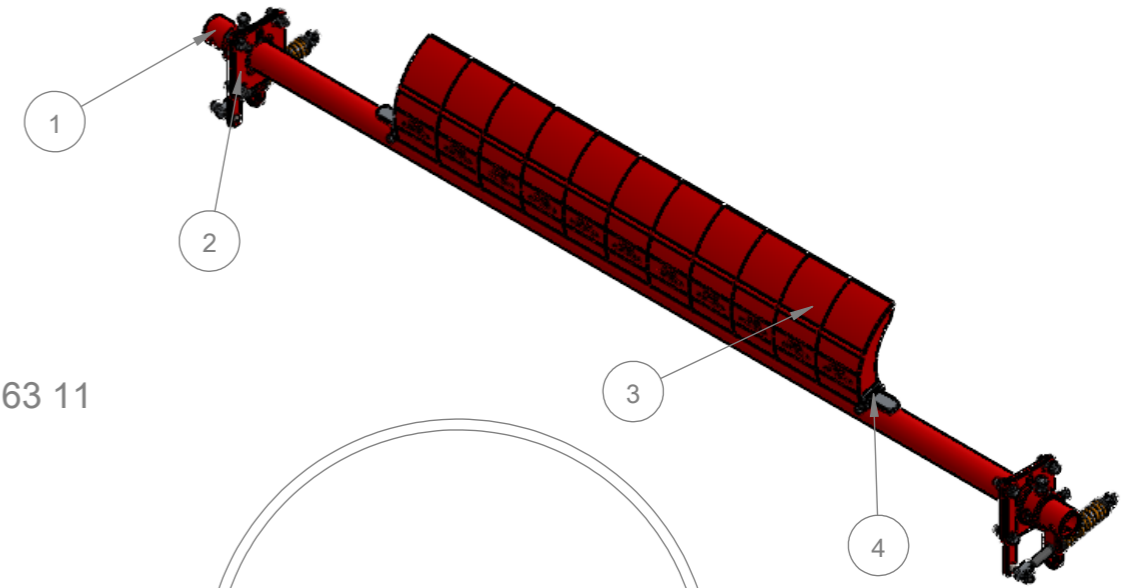

81 161 63 11

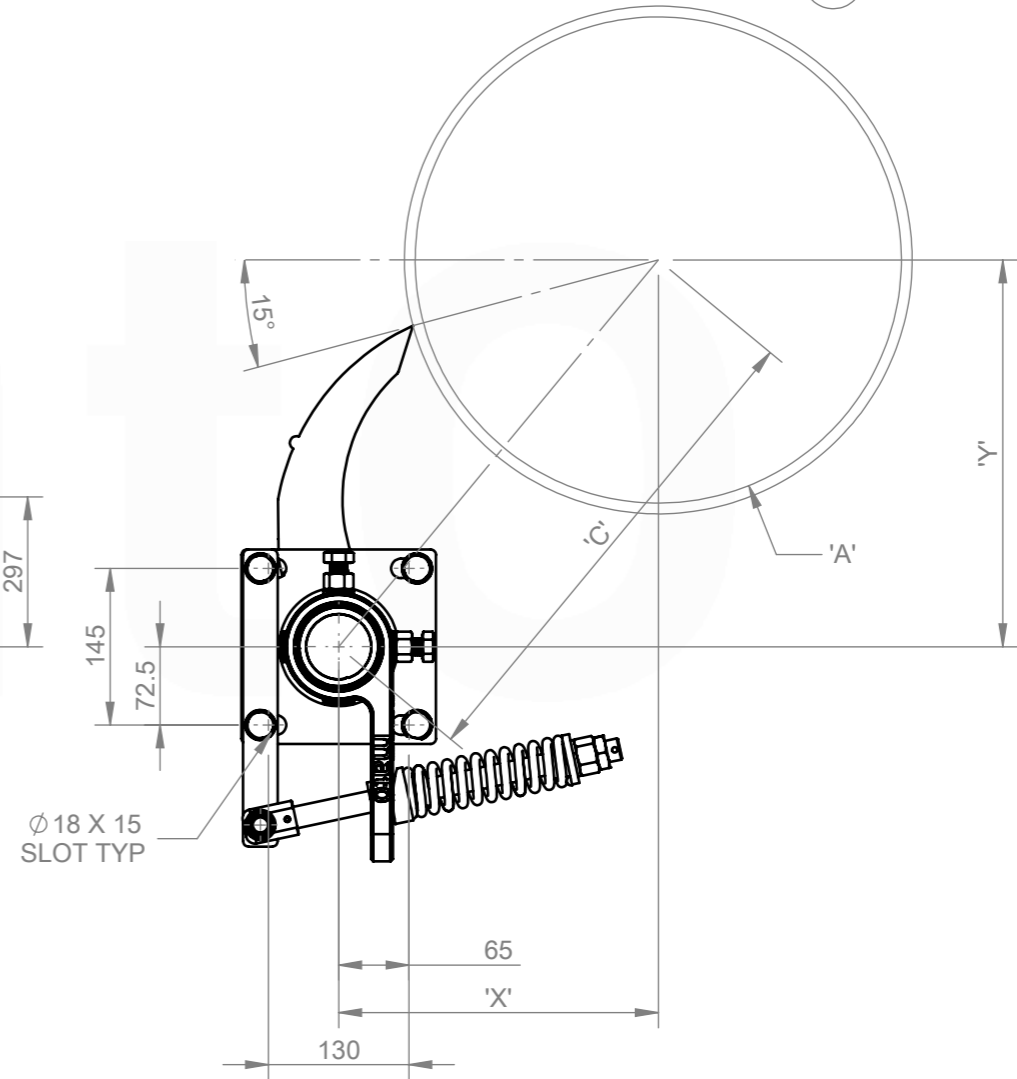
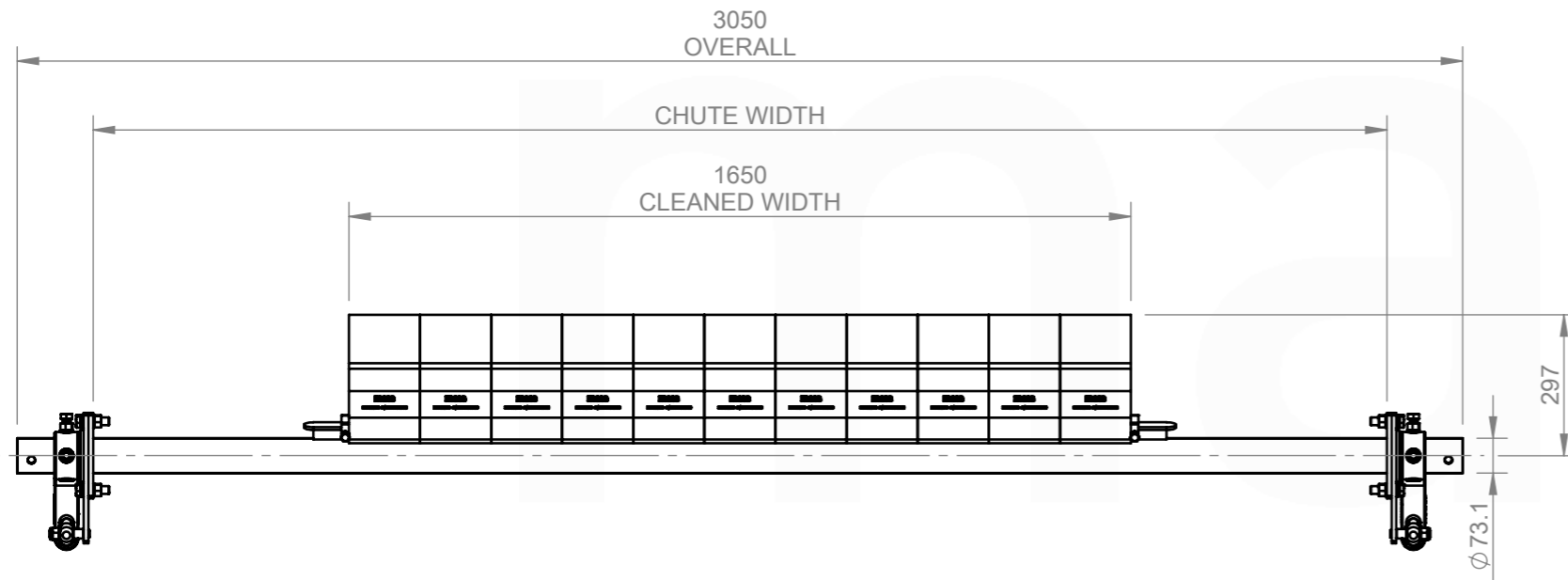

CHUTE CUT OUT DETAIL:
REFER TO CUT OUT TEMPLATE
MTP235 CS2 INSTALLATION TEMPLATE

ITEM NO.	DESCRIPTION	QTY.	PART No.	MASS k/g
1	MTP-73-1800-SS	1	82 024 10	39.86
2	73.0 MD DUAL PRIMARY COMPRESSION SPRING CS2 (YELLOW) END ASSEMBLY	1	81 161 00 80	15.39
3	MDP235 P1 150mm BLADE - FRAS	11	81 110 00 23	2.52
4	END STOP, ASSY. - MTP	2	82 200 00 25	0.20

REV.	DESCRIPTION	BY	APRVD	DATE	MATERIAL:	DRAWN BY	DESCRIPTION:	PROFILE CUT ITEMS:	<p>MATO AUSTRALIA PTY LTD (INCORPORATED IN NSW) ABN 82 050 057 726 39 BONVILLE AVE THORNTON NSW 2322 PH: 1300 850 795 FAX: (02)4936 1388</p>
A	ISSUED FOR CONSTRUCTION	KD	JS	20/11/25	N/A	KD	MTP235-P1-CS2-1800	TO BE CUT FROM SUPPLIED DXF CAD FILE WHERE APPLICABLE. ADDITIONAL DIMENSIONS CAN BE PROVIDED ON REQUEST. DO NOT SCALE IF IN DOUBT.	
B	UPDATED DIMENSIONS	JS	DG	29/01/25	N/A	JS 20/11/25	81 161 63 11	THIS DRAWING IS STRICTLY CONFIDENTIAL AND MUST NOT BE COPIED, REPRODUCED OR ADAPTED, NOR MAY ARTICLES BE MANUFACTURED IN ACCORDANCE WITH THE DRAWING WITHOUT PRIOR WRITTEN PERMISSION OF MATO AUSTRALIA PTY LTD.	
<p>REVISIONS</p>					<p>FINISH: N/A</p> <p>COLOUR: N/A</p> <p>MFG'D: INTERNAL</p> <p>SCALE: DO NOT SCALE</p>	<p>CHECKED: JS 20/11/25</p> <p>APPROVED: JS 20/11/25</p> <p>CREATED: 17/11/2025</p>	<p>MASS: 83.40 KG</p> <p>3RD ANGLE PROJECTION</p>	<p>PG. SIZE: A3</p> <p>SHEET: 1 / 1</p> <p>REV: B</p>	

MACHINING AND FABRICATION TOLERANCES UNO: (ALL DIMENSIONS IN mm)
 DIMENSIONAL TOLERANCE: PIPE STRAIGHTNESS
 X.X ±1.0 <1000 ±3.0
 X.XX ±0.5 <2000 ±6.0
 X.XXX ±0.1 <3000 ±9.0
 X.XXXX ±0.01
 ANGLE: X.X ±1.0° X.XX ±0.5°
 HOLE CENTERS: ±0.5
 THERMAL CUTTING: ±1.0
 WELDMENTS: ±2.0
 CASTINGS: REFER TO CASTING NOTES
 MACHINING "ROUGH" TO ISO 2768-vL
 MACHINING STD: TO ISO 2768-mK
 POLYURETHANE: ±2.0
 WELD SYMBOLS: IN ACCORDANCE TO ISO 2553
 MACHINED SURFACES UNO:
 TO BE $\sqrt{12.5}$ WHERE INDICATED "ROUGH"
 TO BE $\sqrt{3.2}$ WHERE NOT INDICATED

C:\InfoVault\InfoVault\01-Production\NEW FOLDER STRUCTURE\PRIMARY CLEANERS\MTP - PRIMARY CLEANERS\CS2 - END ASSEMBLIES\MTP235\81 161 63 11\CAD FILES\81 161 63 11